

| | | | |
|---|------------------------|-------------------|----------------|
| Room Description: Dental Treatment Room, Two Chair (DNTG3) | NSF: 260 260 | DNTG3 | |
| Sheet Description: Room/Equipment Isometric | Scale: | Sheet 1 | of 5 |

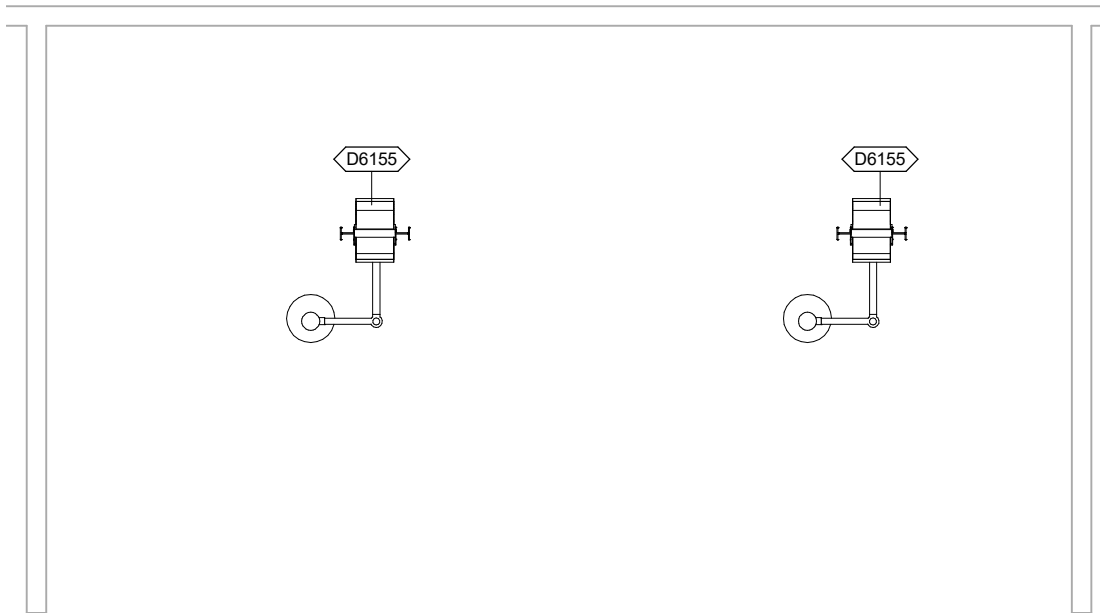

DNTG3 - CEILING MOUNTED EQUIPMENT PLAN

| | | | |
|---|----------------------------|-------------------|----------------|
| Room Description: Dental Treatment Room, Two Chair (DNTG3) | NSF: 260 260 | DNTG3 | |
| Sheet Description: Ceiling Mounted Equipment Plan | Scale: 1/4" = 1'-0" | Sheet 2 | of 5 |

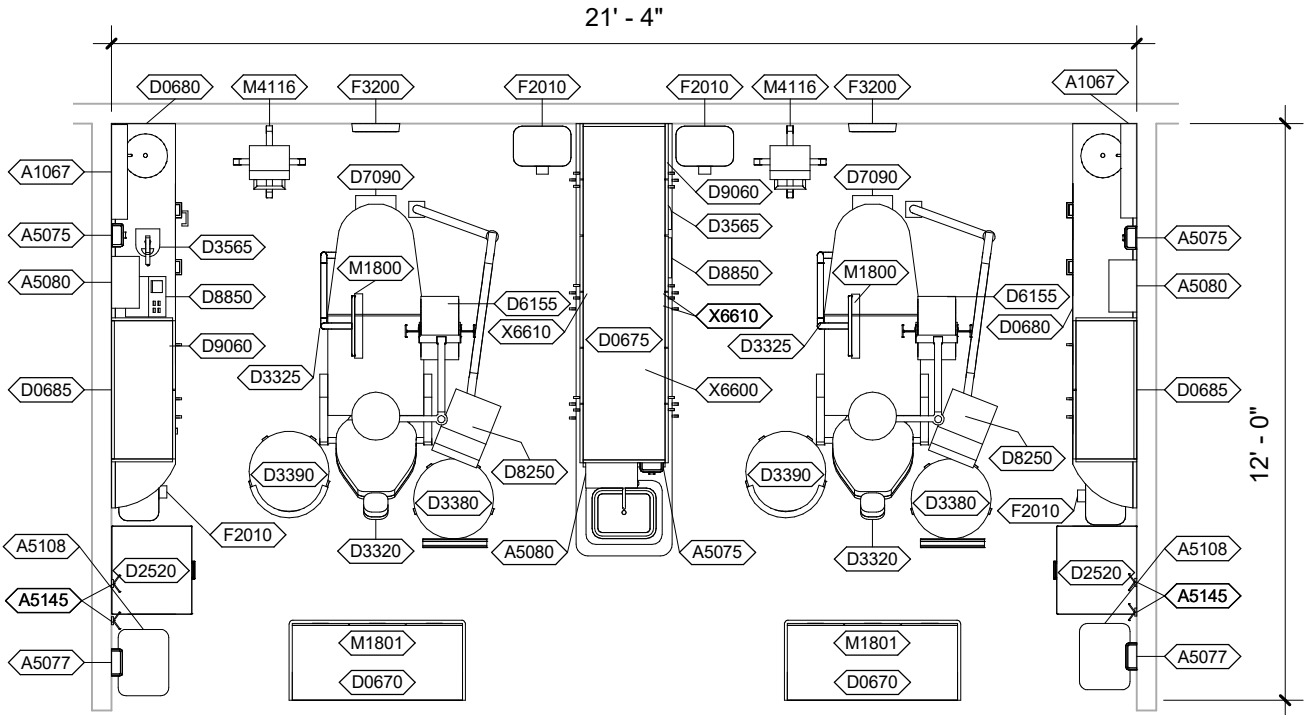

DNTG3 - NOTES

| | | | |
|---|----------------------------|-------------------|----------------|
| Room Description: Dental Treatment Room, Two Chair (DNTG3) | NSF: 260 260 | DNTG3 | |
| Sheet Description: Equipment Plan | Scale: 1/4" = 1'-0" | Sheet 3 | of 5 |

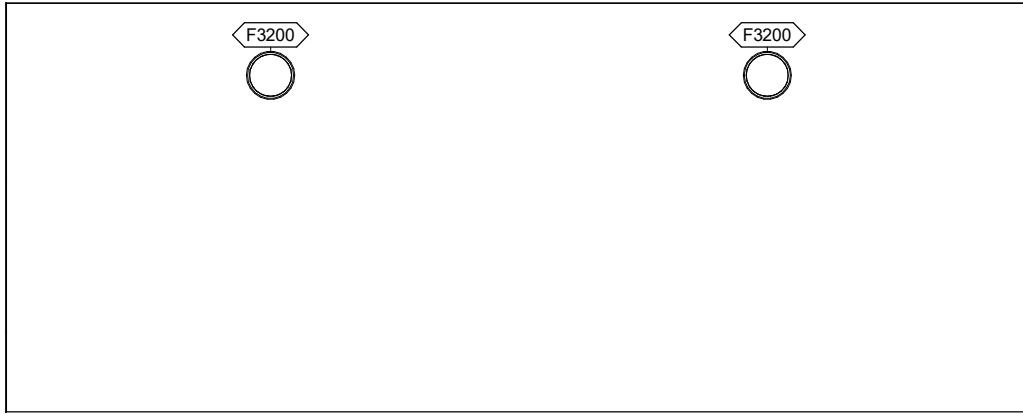

DNTG3 - NORTH ELEVATION

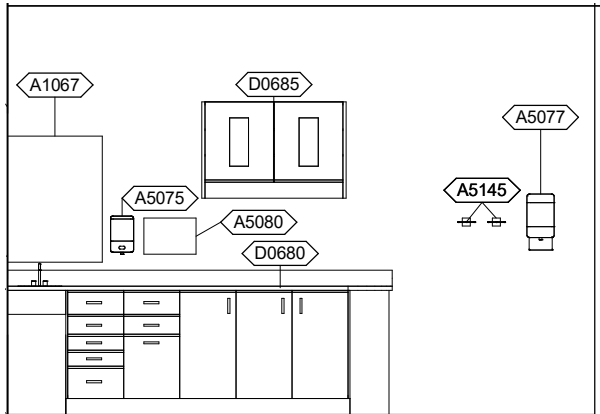

DNTG3 - EAST ELEVATION

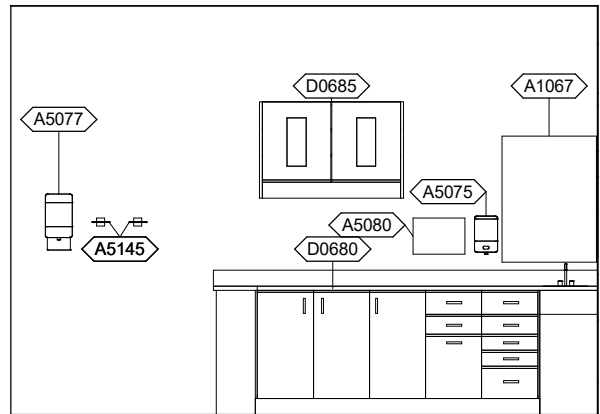

DNTG3 - WEST ELEVATION

| | | | |
|---|----------------------------|-------------------|----------------|
| Room Description: Dental Treatment Room, Two Chair (DNTG3) | NSF: 260 260 | <h1>DNTG3</h1> | |
| Sheet Description: Interior Room Elevations | Scale: 1/4" = 1'-0" | Sheet 4 | of 5 |

DNTG3 - EQUIPMENT SCHEDULE

| JSN | Nomenclature | Qty | LF | Funding Category | LOGCAT |
|-------|---|-----|----|------------------|--------|
| A1067 | Mirror, Float Glass, ADA Accessible | 2 | | RPIE | A |
| A5075 | Dispenser, Soap, Disposable | 3 | | PP | C |
| A5077 | Dispenser, Hand Sanitizer, Hands free | 2 | | PP | C |
| A5080 | Dispenser, Paper Towel, SS, Surface Mounted | 3 | | RPIE | A |
| A5108 | Waste Disposal Unit, Sharps | 2 | | PP | C |
| A5145 | Hook, Garment, Double, SS, Surface Mounted | 4 | | RPIE | A |
| D0670 | Console, Treatment Unit, Dental Operator | 2 | | RPIE | A |
| D0675 | Console, Central, Dual Access, Dental Operator | 1 | | RPIE | A |
| D0680 | Console, Accessory/Side, Dental Operator | 2 | | RPIE | A |
| D0685 | Cabinet, Storage, Dental Operator, Wall MNTD | 2 | | RPIE | A |
| D2520 | Cabinet, Mobile, Storage/Assistant, Dental | 2 | | PP | C |
| D3320 | Chair, Operating, Dental | 2 | | PP | C |
| D3325 | Mount, Monitor, Dental Chair | 2 | | PP | C |
| D3380 | Stool, Operating, Dental, Doctor | 2 | | PP | C |
| D3390 | Stool, Operating, Dental, Assistant | 2 | | PP | C |
| D3565 | Resin Curing Unit, Visible Light | 2 | | PP | C |
| D6155 | Light, Dental, Operating, Ceiling, Column | 2 | | RPIE | A |
| D7090 | Utility Center, Dental, Wall or Floor Mounted | 2 | | RPIE | A |
| D8250 | Delivery System, Dental Operating | 2 | | PP | C |
| D8850 | Amalgamator, Dental | 2 | | PP | C |
| D9060 | Prophylaxis Unit, Ultrasonic | 2 | | PP | C |
| F2010 | Basket, Wastepaper, Step-On | 4 | | PP | C |
| F3200 | Clock, Battery, 12" Diameter | 2 | | PP | C |
| M1800 | Monitor, Computer | 2 | | PP | C |
| M1801 | Computer, Microprocessing, w/Flat Panel Monitor | 2 | | PP | C |
| M4116 | Monitor, Vital Signs | 2 | | PP | C |
| X6600 | Radiographic Unit, Dental, Wall Mounted, 7 mA | 1 | | PP | C |
| X6610 | Sensor, Dental Imaging System | 4 | | PP | C |

| | | | |
|---|------------------------|-------------------|----------------|
| Room Description: Dental Treatment Room, Two Chair (DNTG3) | NSF: 260 260 | DNTG3 | |
| Sheet Description: Equipment Schedule | Scale: | Sheet 5 | of 5 |