

KEY NOTES

1. SLAB SHALL BE RECESSED AT THE AUDIO BOOTH LOCATION IN ORDER TO COMPLY WITH ADA.
2. MOUNT A5245, HOOK, AT 2372 [4'-6"] AFF. PROVIDE 2-A5245'S FOR NAVY PROJECTS ONLY. MOUNT 1-A5145 AT 1372 [4'-6"] AFF AND 1-A5145 AT 1524 [5'-0"] AFF.
3. PROVIDE M4200, OTOSCOPE/OPHTHALMOSCOPE, FOR AIR FORCE AND NAVY PROJECTS.
4. F3200, CLOCK, IS FOR NAVY PROJECTS AND IS OPTIONAL.
5. COORDINATE LOCATION OF M1620, PATIENT CHART HOLDER, AND ROOM SIGNAGE.
6. VERIFY THIS DIMENSION WITH MANUFACTURER'S VENTING REQUIREMENTS FOR THE M0050, AUDIO BOOTH.
7. COORDINATE ELECTRICAL REQUIREMENTS WITH ACTUAL EQUIPMENT PROVIDED.

**PHYSICAL EVALUATION,
HEARING SCREEN, 1 PERSON (PEHS1)**

AUDIOLOGY/SPEECH PATHOLOGY/ENT

FLOOR/EQUIPMENT PLAN 11.15 NSM (120 NSF)

DATE: 07/12/2001

0 1000 2000



1:50 SCALE (MILLIMETERS)

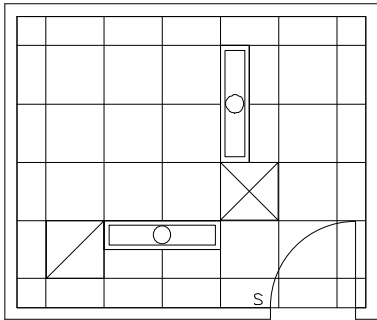

KEY NOTES
 1. VERIFY REQUIRED CEILING HEIGHT WITH MANUFACTURER OF M0050, AUDIO BOOTH.

PHYSICAL EVALUATION,
 HEARING SCREEN, 1 PERSON (PEHS1)

AUDIOLOGY/SPEECH PATHOLOGY/ENT

CEILING PLAN 11.15 NSM (120 NSF)

DATE: 07/12/2001

0 1000 2000



1:50 SCALE (MILLIMETERS)

Project Rooms (User Contents Only)

As of 08/22/2005

Page 1

Room Code: PEHS1 Room Qty: 1 Room Area: 120.01 Room Description: PHYSICAL EVAL, HEARING SCREEN, 1 PERSON

JSN	NOMENCLATURE	Qty	UNIT	LOG	Ut1	Ut1	Ut1	Ut1	Ut1	Ut1
			ISSUE	CAT	1	2	3	4	5	6

Equipment per Room:

A5145	Hook, Garment, Double, SS, Surface Mounted	1	EA	A
F0280	Chair, Swivel, Low Back	1	EA	C
F0295	Chair, Stacking, 34 X 21 X 24	1	EA	C
F0860	Table, Mobile	1	EA	C
F2000	Basket, Wastepaper, Round, Metal, 18 H x 16 Dia.	1	EA	C
F3200	Clock, Battery, 12" Diameter	1	EA	C
M0030	Audiometer, Diagnostic	1	EA	C	.	A
M0050	Booth, Audio, Dbl Wall, Definitive Test, 1 Perso	1	EA	A	.	F
M1620	Holder, Chart, Patient, Wall or Door Mounted	1	EA	A
M4200	Otoscope/Ophthalmoscope, Wall Mounted	1	EA	C	.	A

=====
10

GRAND TOTAL