

Notes: Component Functions

- a.) Completes aesthetic affect.
- b/c) Provides structural support to other wear surface.
- d.) Protects membrane from further const.
- e.) Prevents moisture entry.
- f.) Provides uniform slab base for further const.
- g.) Promotes water flow to subdrain pipes or sumps
- h.) Slab system foundation material.

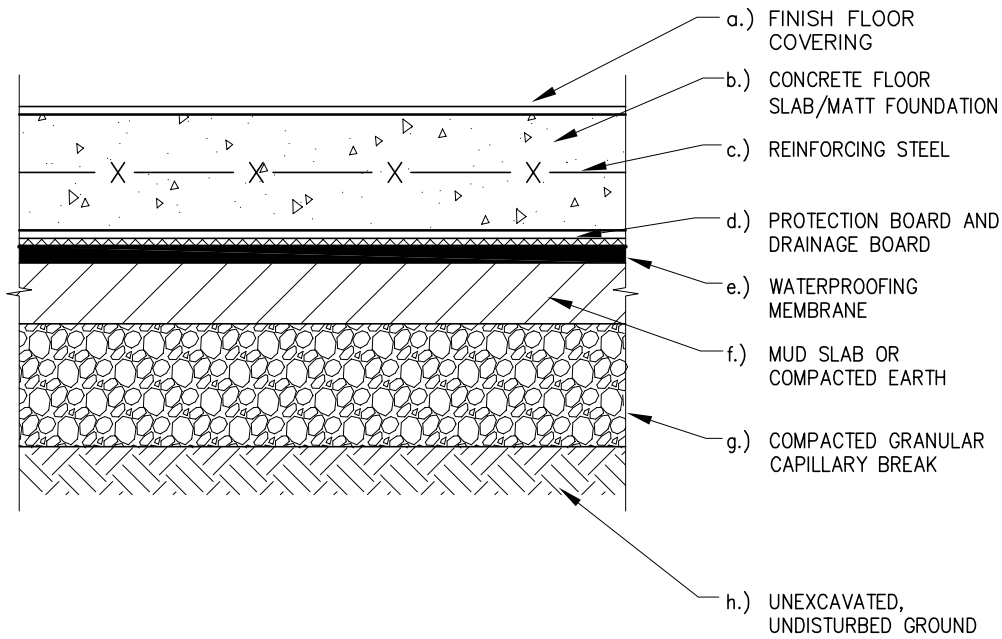

1.3.2

**BELOW GRADE SLAB -
WATERPROOF SYSTEM**

CONCEPTUAL – NOT FOR CONSTRUCTION